

Thermoelectric cooler



Description

Order Number:	388708-3
Brand Name:	SOLITHERM PELTIER
Housing Material:	Stainless steel AISI 304 (V2A)
Ingress protection to EN 60 529:	IP 66 / UL Type 12, 4, 4X
Note:	Das Anziehdrehmoment der Schrauben muß 4.5 Nm betragen. Niehoff Material Nr. 388708-3
Approvals:	CE, cURus

Technical data

Cooling capacity 95F/95F:	75 W
Air volume flow (system / unimpeded):	Ambient air circuit: 116 / 306 m ³ /h Cabinet air circuit: 58 / 182 m ³ /h
Operating temperature range:	-4°F - 158°F
UL temperature range:	-4°F - 149°F
Mounting:	Halbeinbau / Wandanbau
Dimension H x W x D:	250 x 203 x (86+74) mm
Cut out dimensions:	210 x 160 mm
Voltage / Frequency:	24 V DC
Current 95F95F:	4.6 A
Starting current:	6.9 A
Max. current:	5.3 A
Power consumption:	110 W
Max. power:	127 W
Fuse:	8 A (T)
Connection:	6 - poliger Anschlussstecker

Performance graph:

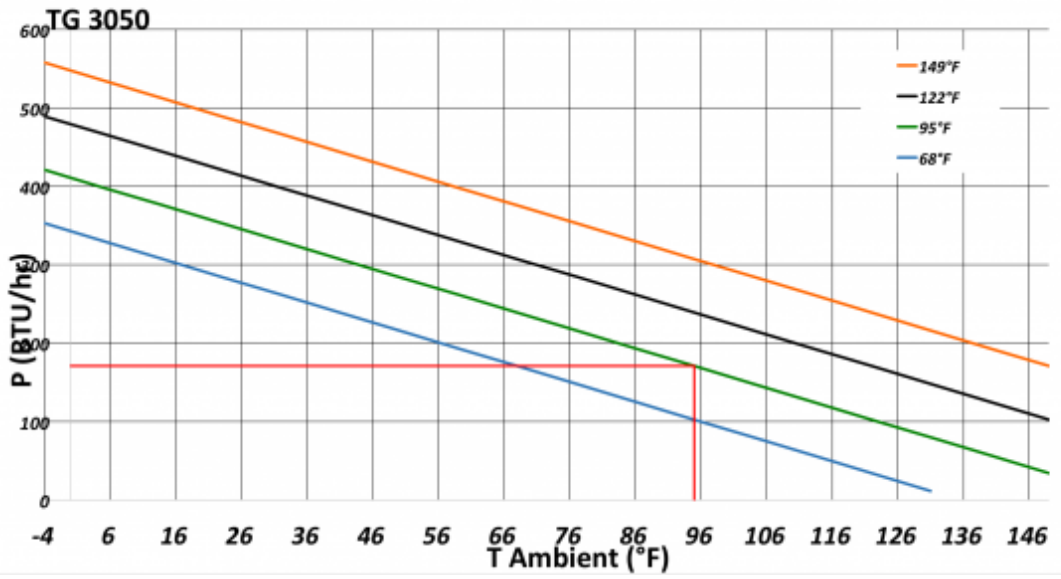

Air flow:

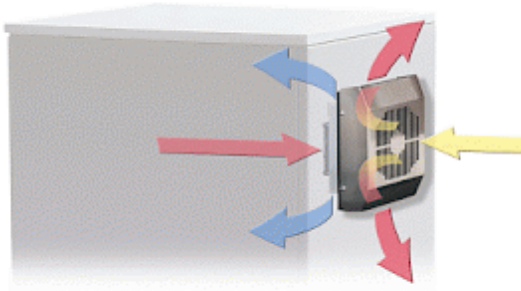

Dimensions:

